

## Juegos de Soportes para mamparas anticontagio

Soportes en aleación de Aluminio anodizado mate AW-6060 para pantallas protectoras con bases anti-deslizantes.

Montaje fácil y seguro. El vidrio se introduce en el perfil sin tornillos. Bases desmontadas. Máxima durabilidad y resistencia a la corrosión.

### ALU240 AERO

(Código Producto: C0530004)

### ALU700 FORTE

(Código Producto: C0530005)

### ALU800 FORTE



(Código Producto: C0530007)

### Contenido

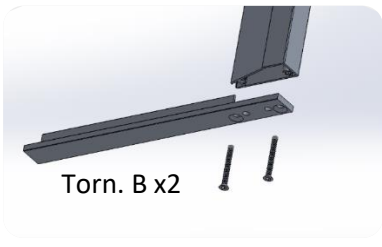
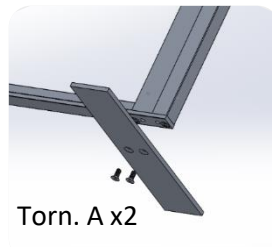
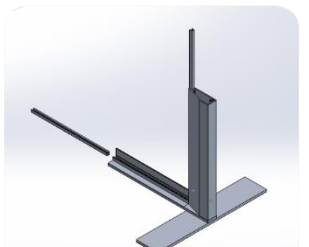

### Instrucciones de montaje

Primero montar la parte derecha como se muestra a continuación y después repetir los pasos con la parte izquierda.

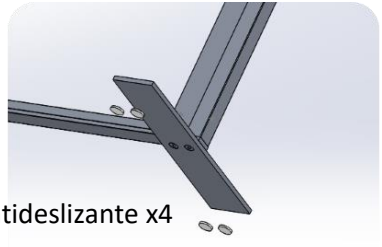
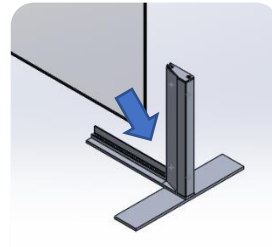
- 
- Sacar vidrio del embalaje
- 
- 1.- Atornillar el horizontal al vertical
- 
- 2.- Atornillar el pie
- 
- 3.- Introducir los junquillos (deslizándolos)
- 
- 4.- Atornillar la tapa
- 
- 5.- Pegar los antideslizantes
- 
- 6.- Introducir el vidrio a presión

### Instrucciones de Limpieza

Limpiar a mano con agua tibia, jabón, o detergente, mediante esponja o bayeta. Evitar detergentes que contengan cloro, productos con ácido en general o limpiadores agresivos. No usar estropajos o esponjas metálicas o materiales abrasivos, los cuales dañarían de forma irreversible el recubrimiento.

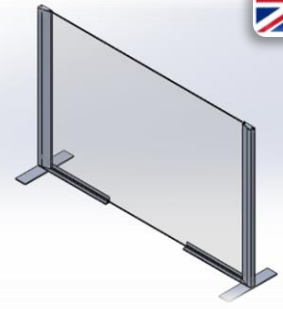
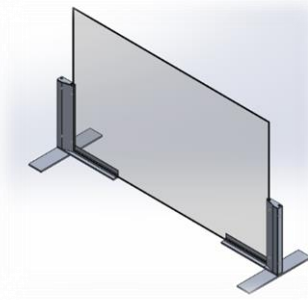

## Aluminium Supports for Protective Screens

Silver matt anodised AW-6060 aluminium alloy support with non-slip pads for protective screens.

Easy and secure press-in glass assembling.  
 Durable and corrosion-resistant finish.

### ALU240 AERO

(Product code: C0530004)

### ALU700 FORTE

(Product code: C0530005)

### ALU800 FORTE

(Product code: C0530007)

### Content



### Assembling instructions

There are 2 sides, left and right, to be assembled. Start with the right-side support following these instructions and repeat them with the left-side support.



Carefully remove the glass screen from the packaging

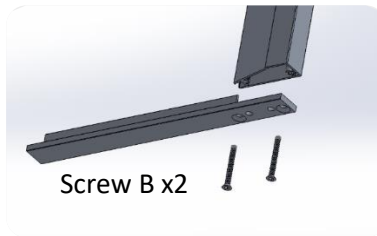

1.- Screw standing leg to right support bar

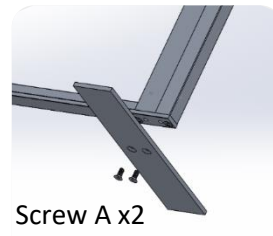

2.- Screw the L support to the base

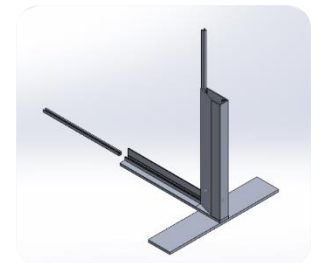

3.- Slide in the glass plastic channels



4.- Screw the top cap

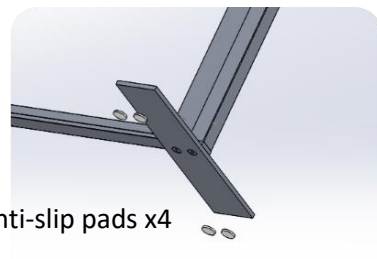

5.- Stick the self-adhesive pads

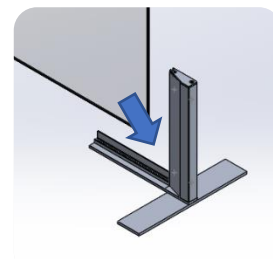

6.- Press in the glass to secure

### Cleaning Guidance

Hand washing using warm water, soap, or detergent, applying with sponge or soft cloth. Please avoid detergents that contain chlorine or its by-products, as muriatic acid, or bleach. Do not use steel wool or abrasive materials which could irreparably scratch the surface.